

R1-350 Pro**1-Channel Remote Amp for SCM50/100/105/110/150****Overview**

1-channel 6U/19" rack mount amplifier to partner SCM50/100/105/110/150AiV Pro and SCM50/100/150Ai Pro loudspeakers.

Remote amp drives a single loudspeaker:

Speaker level audio connections via Neutrik NL8 connectors.

Amp Power / Limit LED connections via 5-pin XLR.

Speaker & LED cable assemblies supplied separately and built to order. Lengths must be specified.

Electronic specifications

Balanced Input: Front Panel Mounted Female XLR, pin 2 hot.

Input Impedance: 20k Ω (differential).

Input CMRR: >82dB (10kHz).

Input Sensitivity: 2.2dBu/1Vrms for full power.

Input Sensitivity Control: Continuously Variable from 2.2dBu-8.2dBu/1Vrms-2Vrms (-6dB).

Bass Boost Control: Continuously variable from 0dB to +6dB.

Crossover Filters: 4th Order Linkwitz-Riley at 380Hz and 3.5kHz.

Amplifier type: Grounded Source MOSFET based Class A/B, convection cooled.

Output Power: Bass 200W (8 Ω), Mid 100W (16 Ω), HF 50W (6 Ω).

Frequency Response: <2Hz to >200kHz (-3dB).

THD+N: <0.003%/-92dB (1kHz, 1dB below rated power; 90kHz BW).

Limiter: ATC Active FET Momentary Gain Reduction, limiter 'active' indicated via LED on speaker front panel.

Speaker Level Output: Rear Panel Mounted Neutrik NL8.

Power/Clip LED Output: 1x Rear Panel Mounted 5-Pin Female XLR.

Mains Input: 220-230V or 115V – Factory set. Please observe panel markings and labels!

Power Consumption: Idle 37W/51VA. 1/8th Power 132W/178VA. Full Power 321W/403VA.

Heat Output: Idle 126 BTU/hr. 1/8th power 366 BTU/hr. Full Power 413 BTU/hr.

Physical specifications

See following page.

R1-350 Pro**1-Channel Remote Amp for SCM50/100/105/110/150**ATC reserve the right to change specifications without prior notice
Acoustic Transducer Co. is a trading name and ATC is the registered Trade Mark of Loudspeaker Technology Ltd.

Net Weight: 15.9kg/35lbs.

Dimensions...

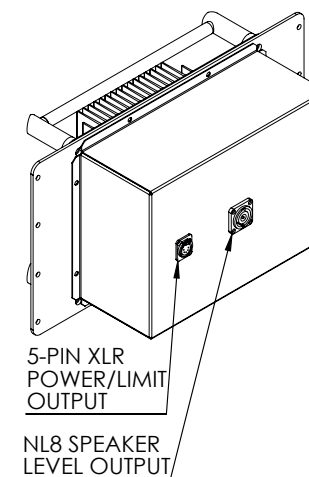
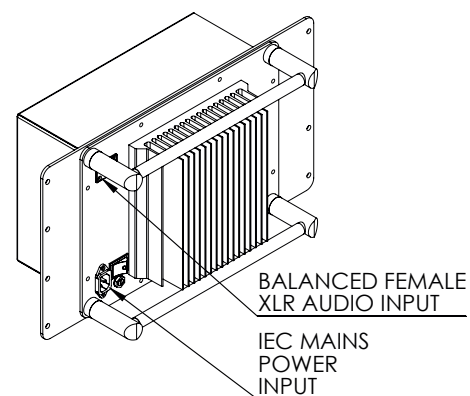
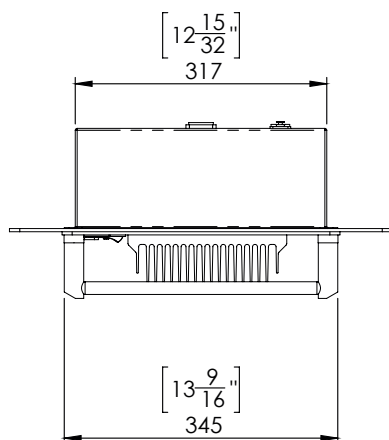
R1-350 PROAMPS ARE CONVECTION COOLED.
INSTALL IN A COOL WELL VENTILATED SPACE.